

CHINA-WATER-METER.COM

SANLIAN WATER METER

[HOME](#) [COMPANY BRIEF](#) [WATER METER](#) [CERTIFICATES](#) [CONTACT US](#) [E-MAIL](#)

| Products Catalogue | Home ---> Water Meter ----> Volumetric Rotary Piston Type Water Meter ---> LXH-15 |
|--|---|
| <p>Volumetric ▶ Piston Type Water Meter</p> <p>Multi-Jet ▶ Water Meter</p> <p>Single-Jet ▶ Water Meter</p> <p>Dry-Dial ▶ Water Meter</p> <p>Wet-Dial ▶ Water Meter</p> <p>Liquid-sealed ▶ Water Meter</p> <p>Woltman ▶ Type Water Meter</p> <p>Hot Water ▶ Meter</p> | <p>▶ LXH-15 Volumetric Rotary Piston Type Cold Water Meter</p>  <p>▶ Application: This range of water meter is used to measure the total quantity of cold potable water which consumed in household or a resident unit, passing through the pipeline.</p> <p>▶ Feature: Adopt volumetric rotary piston principle of measurement with conformity to ISO 4064 Class C and D. High sensitivity enables the accurate measurement even at a low flow rate of 4 L/H. No Location limitation for installation. Accuracy is not to be affected wherever installed at a horizontal, vertical or inclined pipeline. Register is sealed with a special liquid to keep a clear reading in long term service. Mechanical parts use of high-quality material to ensure a stable characteristic.</p> <p>▶ Working Condition: Water temperature: ≤50°C Working pressure: ≤1MPa</p> |

► **Compliance With Standard:**

ISO 4064 Class C, D

► **Main Technical Data:**

| Type | Meter Size mm | Class | qs Max Flow | qp Nominal Flow | qt Transitional Flow | qmin Min Flow | Starting Flow | Min Reading | Max Reading |
|--------|------------------|-------|-------------------|-----------------------|----------------------------|---------------------|------------------|----------------|----------------|
| | | | m3/h | | l/h | | | m3/h | |
| LXH-15 | 15/18 | C | 3 | 1.5 | 22.5 | 15 | 4 | 0.0001/0.001 | 9999/99999 |
| | | D | | | 17.25 | 11.25 | | | |

► **Dimensions And Weight:**

| Type | Meter Size | Length (L) | Width (B) | Connecting Thread D | Weight kg |
|--------|------------|------------|-----------|---------------------------|--------------|
| | mm | | | | |
| LXH-15 | 18/15 | 115 | φ86/φ88 | G 3/4 B | 0.85/1.1 |

► **Head Loss Curve:**

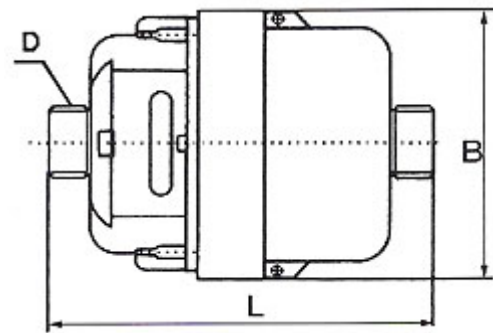
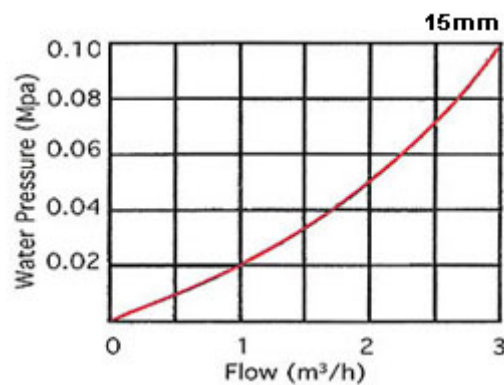

► **Flow Error Curve:**

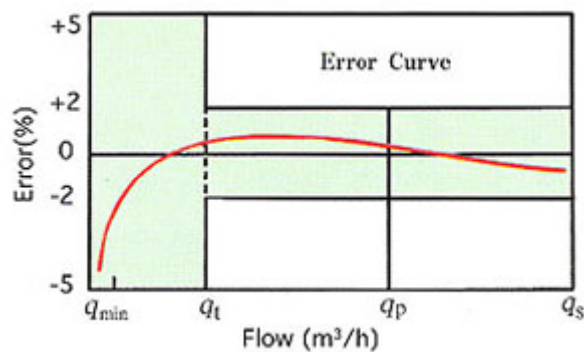

► **Indicating Error:**

- a) In the lower zone from Q_{min} inclusive up to but excluding Q_t is $\pm 5\%$
- b) In the upper zone from Q_t inclusive up to and including Q_s is $\pm 2\%$

Fenghua Sanlian Water Meter Co., Ltd.

Add: West Road No. 68, Shangtian Town, Fenghua, Zhejiang, China
 Tel: 86-0574-81802260 Fax: 86-0574-87774352 Postcode: 315511
 E-mail: watermeter@163.com Contact: Jason Chang

